



COUNTY OF SAN JOAQUIN

DEPARTMENT OF PUBLIC WORKS
P.O. BOX 1810-1810 E. HAZELTON AVENUE
STOCKTON, CALIFORNIA 95201
(209) 468-3000
FAX # (209) 468-9324

Permit No: PS-1603332
Date Issued: 10/20/2016
Start Date: 10/21/2016
Exp. Date: 02/15/2017
Project No: PWP730052
Quad: LV

UE/CR/PM NO:31190200

ENCROACHMENT PERMIT

To: PACIFIC GAS & ELECTRIC - STOCKTON
PO BOX 930
STOCKTON, CA 95201

Encroachment Type:

Road Closure for	Pole Replacement		
------------------	------------------	--	--

Location:

DOUGLAS RD. 600' E/O WILLIAMSBURG PL.

In compliance with your request of **10/20/2016**, permission is hereby granted to do work in County right-of-way as shown on attached application and subject to all the terms, conditions and restrictions written below or printed as general or special provisions on any part of this form. See reverse side and attached sheet, if any.

Trench excavations for service connections will not be permitted within ten feet (10') of pavement centerline unless otherwise approved by the Director. Surface of trench patches shall match in kind and be smooth and even with that of abutting surface. Special attention shall be given to depth of utilities through roadside area in anticipation of future drainage facilities, road profile and/or frontage development. All underground utility facilities are to be established and accurately dimensioned on sketches from surveyed centerline of road right of way, or from right of way (border) lines.

Permittee shall call the Department of Public Works, Field Engineering Division (Permit Inspections) at (209)953-7421 at least forty-eight hours prior to beginning any work within the County right of way. All work performed under this permit shall conform to the rules and regulations pertaining to safety established by the California Division of Industrial Safety and Cal-OSHA.

The jobsite shall be kept in a safe condition at all times by the daily removal of any excess dirt or debris which might be a hazard to either pedestrian or automobile traffic. All necessary traffic convenience and warning devices and personnel shall be provided, placed and maintained by and at the sole expense of the Permittee in accordance with the latest edition of the CALTRANS Manual of Traffic Control.

After completion of the work permitted herein, all debris, lumber, barricades, or any excess material shall be removed and the jobsite left in a neat workmanlike manner. Immediately following completion of construction permitted herein, Permittee shall fill out and mail notice of completion (see attached post card) provided by Grantor.

Special Comments:

Traffic Control Per MUTCD*****See Attached "Special Conditions"*****1-DAY FULL ROAD CLOSURE ALLOWED ON NOVEMBER 30, 2016 FROM 9:00 AM to 4:00 PM*****All other work is prep work with no road closures necessary*****

FORMS: SS/WW

Est. Permit Fee: \$436.00

WHITE -Permittee
GOLDENROD -PWD Central File
YELLOW -Field Inspection
PINK -Permit Section

KRIS BALAJI, Director
Department of Public Works

By:

Alex Chetley
Permit Section

ENCROACHMENT PERMIT GENERAL PROVISIONS

13-1.

1. This permit is issued under and subject to all laws and ordinances of agencies governing the encroachment herein permitted. See the following references:

STREETS AND HIGHWAYS CODE

1. Division 1, Chapter 3
2. Division 2, Chapter 2, Section 942
3. Division 2, Chapter 4, Section 1126
4. Division 2, Chapter 5.5 and Chapter 6

SAN JOAQUIN COUNTY ORDINANCES NUMBERED: 324, 441, 648, 662, 672, 695, 700, 860, 892, 3359, and 3675.

2. It is understood and agreed by the Permittee that the performance of any work under this permit shall constitute an acceptance of all the provisions contained herein and failure on the Permittee's part to comply with any provision will be cause for revocation of this permit. Except as otherwise provided for public agencies and franchise holders, this permit is revocable on five days notice.
3. All work shall be done subject to the supervision of and the satisfaction of the grantor. The Permittee shall at all times during the progress of the work keep the County Highway in as neat and clean condition as is possible and upon completion of the work authorized herein, shall leave the County Highway in a thoroughly neat, clean and usable condition.
4. The Permittee also agrees by the acceptance of this permit to properly maintain any encroachment structure placed by the Permittee on any part of the County Highway and to immediately repair any damage to any portion of the highway, which occurs as a result of the maintenance of the said encroachment structure, until such time as the Permittee may be relieved of the responsibility for such maintenance by the County of San Joaquin.
5. The Permittee also agrees by the acceptance of this permit to make, at its own expense, such repairs as may be deemed necessary by the County Department of Public Works.
6. It is further agreed by the Permittee that whenever construction, reconstruction or maintenance work upon the highway is necessary, the installation provided for herein shall, upon request of the County Department of Public Works, be immediately moved or removed by and at the sole expense of the Permittee.
7. No material used for fill or backfill in the construction of the encroachment shall be borrowed or taken from within the County right of way.
8. All work shall be planned and carried out with as little inconvenience as possible to the traveling public. No material shall be stacked within eight feet (8') of the edge of the pavement or traveled way unless otherwise provided herein. Adequate provision shall be made for the protection of the traveling public. Traffic control standards shall be utilized including barricades; approved signs and lights; and flagmen, as required by the particular work in progress.
9. The Permittee, by the acceptance of this permit, shall assume full responsibility for all liability for personal injury or damage to property which may arise out of the work herein permitted or which may arise out of the failure of the part of the Permittee to properly perform the work provided under this permit. In the event any claim of such liability is made against the County of San Joaquin or any department, official or employee thereof, the Permittee shall defend, indemnify, and hold each of them harmless for such claim.
10. All backfill material is to be moistened as necessary and thoroughly compacted with mechanical means. If required by the County Director of Public Works, such backfill shall consist of gravel or crushed rock. The Permittee shall maintain the surface over structures placed hereunder as may be necessary to insure the return of the roadway to a completely stable condition and until relieved of such responsibility by the County Department of Public Works. Wherever a gravel, crushed rock or asphalt surface is removed or damaged in the course of work related to the permitted encroachment, such material shall either be separately stored and replaced in the roadway as nearly as possible in its original state or shall be replaced in kind, and the roadway shall be left in at least as good a condition as it was before the commencement of operations of placing the encroachment structure.
11. Whenever it becomes necessary to secure permission from abutting property owners for the proposed work, such authority must be secured by the Permittee prior to starting work.
12. The current and future safety and convenience of the traveling public shall be given every consideration in the location and methods of construction utilized.
13. The Permittee is responsible for the preservation of survey monuments located within the area of work herein permitted. Prior to the start of construction, survey monuments that potentially may be disturbed shall be located and referenced by a Licensed Land Surveyor, and a Corner Record filed with the County Surveyor. Any Survey Monuments disturbed during the course of construction shall be reestablished by a Licensed Land Surveyor and another Corner Record filed with the County Surveyor. (Land Surveyors' Act Section 8771)
14. Prior to any excavation, the Permittee shall notify USA North (Underground Service Alert of Northern California and Nevada) at 811 or 800-227-2600 forty-eight (48) hours in advance.

SPECIAL CONDITIONS FOR
PM 31190200
ENCROACHMENT PERMIT

1. Maintain traffic controls for all roads. Traffic control delays shall not exceed 15 minutes. Two-way traffic shall be maintained during non-working. During working hours, two-way traffic control shall be maintained with one lane open and appropriate flaggers.
2. Full road closure allowed for 1-day only on November 30, 2016 from 9:00 AM to 4:00 PM on Douglas Road.
3. Access for local traffic, pedestrian traffic and emergency services shall be maintained at all times.
4. Applicant shall notify and coordinate with all emergency services (fire, police, etc.), local schools and the local postmaster a minimum of seven days prior to the road closure.
5. School buses shall be passed through the work zone with minimal delay. Children walking to school shall be escorted through the work zone.
6. Access to all properties shall be maintained at all times except when work is occurring at the access point. Minimal delays will be allowed to provide access within the work zone area. Driveway access shall be fully restored at the end of each workday.
7. Residents and businesses shall be notified in writing, as approved by the County, 48 hours in advance of any impacts to their access.
8. Any areas where parking is to be restricted shall have signs noting the restrictions in place at least 24 hours in advance.
9. The Permittee is responsible for the preservation of survey monuments located within the area of work herein permitted. Prior to the start of construction, survey monuments that potentially may be disturbed shall be located and referenced by a Licensed Land Surveyor, and a Corner Record filed with the County Surveyor. Any Survey Monuments disturbed during the course of construction shall be reestablished by a Licensed Land Surveyor and another Corner Record filed with the County Surveyor. (Land Surveyors' Act Section 8771)
10. The contractor shall not conduct construction operations in rain or heavy fog conditions.

RECEIVED
SAN JOAQUIN COUNTY

2016 OCT 17 PM 3:22

APPLICATION FOR ENCROACHMENT PERMIT
DEPT. OF PUBLIC WORKS

PLEASE PRINT:

Date 9-28-2016

To: San Joaquin County
Department of Public Works

PG&E PM 31190200
(Applicant Name)

4040 West Lane
(Mailing Address)

Stockton, CA 95204
(City, State, Zip Code)

(209)373-9432 rxd2@pge.com
(Area Code - Telephone Number)

OFFICE USE ONLY

JOB #	<u>130052-6</u>	REF #	
APN		CR #	
EXP. DATE	<u>2/15/17</u>		
VALID	<u>10/21/16</u> TO <u>2/15/17</u>	DRIVEWAYS:	
STREET	<u>Douglas Rd.</u>		
AREA	<u>Stockton QUAD LV</u>		
TYPE	<u>Temp. Road Closure</u>		
FORMS	<u>Safew, Special Conditions</u>		
NOTES			

Sketch (Detailed plans may be submitted)

See Sketch

The undersigned hereby applies for permission to excavate, construct and/or otherwise encroach on County Highway Right-of-Way on the Both side of Douglas Rd approximately 600 to 700 (feet/mile) E of Williamsburg PL, Stockton, by performing the following work (description of work):

Replace Deteriorated Pole r/o 1934 Douglas

Full Rd Closure 600' to 700' E of Williamsburg on 11/30/16
from 0900 - 1600 hrs.

Work will commence on or about Prep 10-5-16 for approximately 2 days.

END 2-15-17

I, the undersigned, certify that I am the owner of the respective property, or am qualified to represent the owner and agree to do the work described above in accordance with the rules and regulations of San Joaquin County and subject to inspection and approval.

Roland Davis
Signature of Applicant - Title

9-28-2016
Date

↑
N

VICINITY SKETCH

↑
N

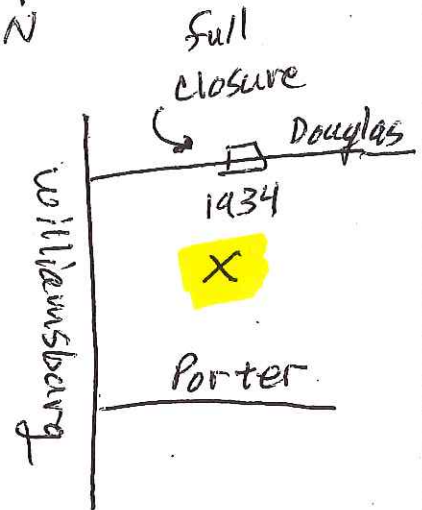

38.00259

-121.33440

Row — — — — Row

Douglas Ave

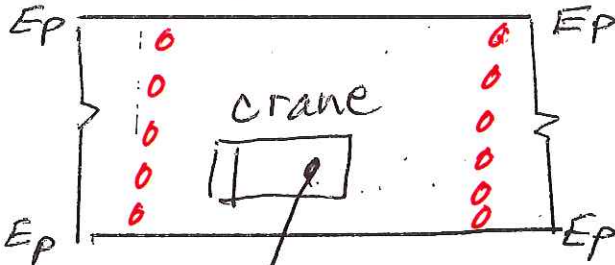

Row — — — — Row

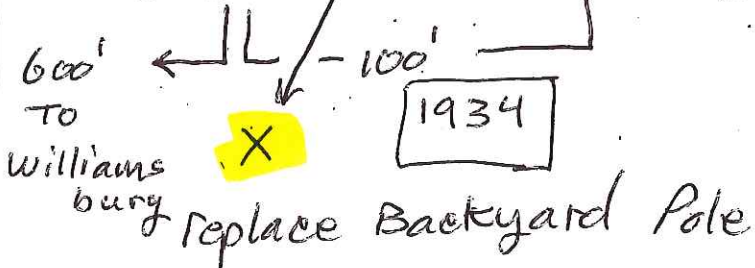

LEGEND

--- Row. LINE
— EDGE OF PAVEMENT

EST: ADAM VOGELAAR

ADE:

SUPV:

REP:

PLNR:

SCALE: NTS

DATE:



PERMIT SKETCH

REPLACE DETERIORATED POLE

R10 1934 Douglas Rd, Stockton

PACIFIC GAS AND ELECTRIC COMPANY

SJCO

CO:

SD:

NOTIF:

OTHER:

SHT: 1 OF 1

SHEETS

PM:

REV.

31190200

mph	feet	CONES	SPACING	TAPER	TANGENT
25	125'	100'	25'	50'	
30	180'		30'	60'	
35	245'		35'	70'	
40	320'		40'	80'	
45	540'		45'	90'	
50	600'		50'	100'	
Shifting(1/2taper)		Shoulder(1/3taper)			

ELEC

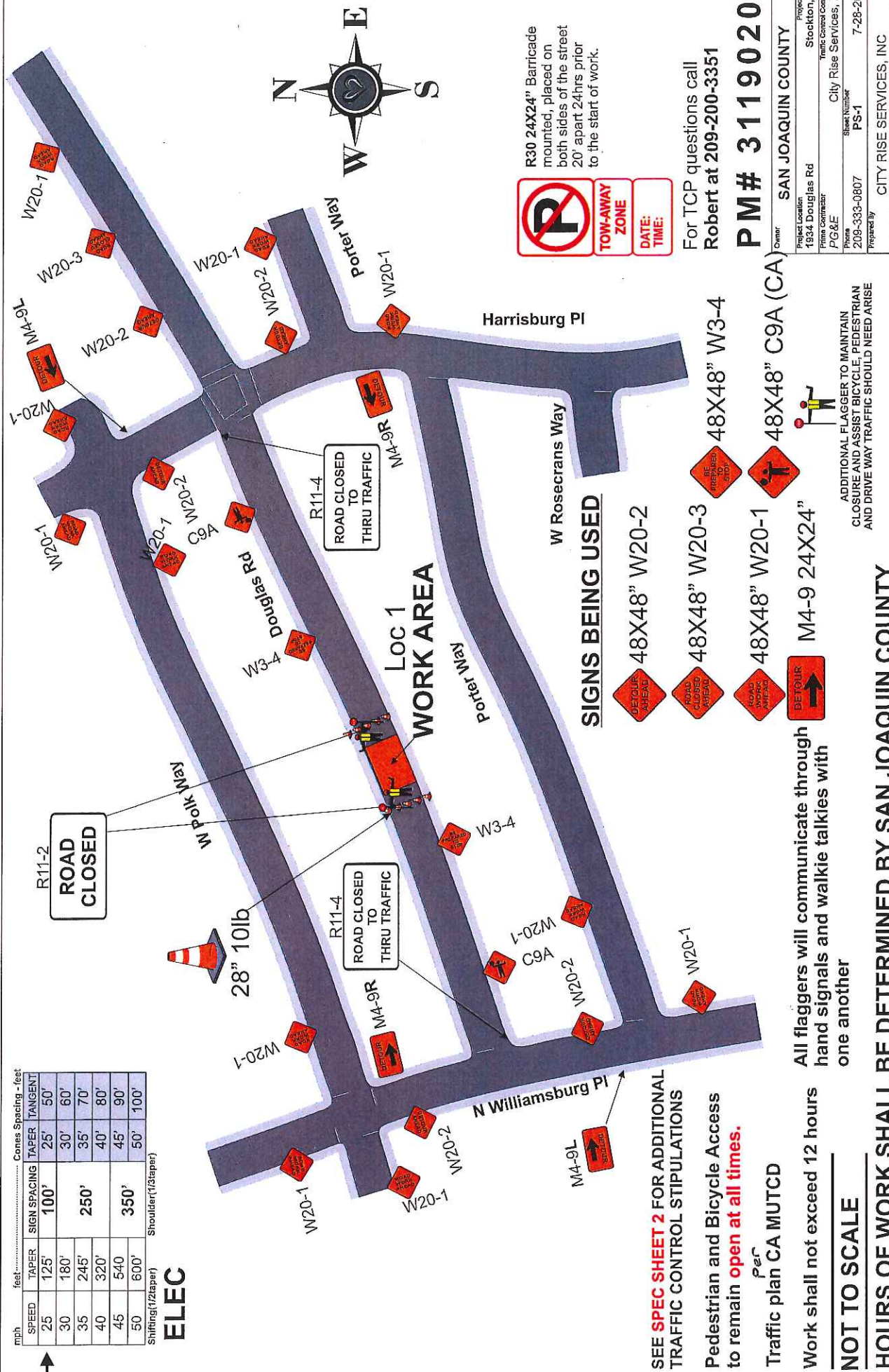

SEE **SPEC SHEET 2** FOR ADDITIONAL TRAFFIC CONTROL STIPULATIONS

Pedestrian and Bicycle Access to remain **open** at all times.

Traffic plan CA MUTCD

Work shall not exceed 12 hours

NOT TO SCALE

HOURS OF WORK SHALL BE DETERMINED BY SAN JOAQUIN COUNTY

All flaggers will communicate through hand signals and walkie talkies with one another

ADDITIONAL FLAGGER TO MAINTAIN CLOSURE AND ASSIST BICYCLE, PEDESTRIAN AND DRIVE WAY TRAFFIC SHOULD NEED ARISE



R30 24X24" Barricade mounted, placed on both sides of the street 20' apart 24hrs prior to the start of work.

For TCP questions call Robert at 209-200-3351

PM# 31190200

Owner		SAN JOAQUIN COUNTY	
Project Location	1934 Douglas Rd	Project City	Stockton, CA
Prime Contractor	PG&E	Traffic Control Contractor	City Rise Services, Inc.
Project Number	209-333-0807	Sheet Number	PS-1
Prepared By	CITY RISE SERVICES, INC.		
		7-28-2016	

**CLOSURE STIPULATIONS AND REQUIREMENTS THAT MUST BE FOLLOWED
AT ALL TIMES. DRIVE ACCESS SHALL REMAIN OPEN OR ACCESSIBLE AT ALL TIMES**

- All lane closures shall meet or exceed CA MUTCD 2014 specifications as well as conform to hours of work set forth by the County.
- Notify the affected adjacent properties of lane closures, 24 hours prior to work.
- All areas of work when encroaching upon sidewalk access OR pedestrian safety shall have the latest CA MUTCD 2014 Edition, Temporary Traffic Control, sidewalk closure detail in place to ensure pedestrian and public safety.
- Pedestrian traffic shall at all time have a minimum 5' feet wide area of travel.
- All open excavation areas shall be backfilled or trench plated during non-working hours and prior to public usage. Plating shall be non-skid surface type.
- All closures set forth in this TCP are the minimum allowed on project, field conditions may change requiring further traffic safety devices or traffic control person to ensure safety of traveling public, pedestrians as well as work forces.
- All traffic control devices, vehicles and personnel must be suited for the purpose intended as well as meet or exceed latest CA MUTCD 2014 Edition, Temporary Traffic Control requirements as well as the County requirements.
- All Devices shall be removed when no longer required.
- All flaggers shall be certified and all intersections shall be flagged when required as shown on plans.
- If work is done at night or encroaches on the hours of darkness all road work ahead signs shall have a flashing beacon, light towers will be used for flaggers and work areas and all other latest CA MUTCD 2014 Edition, Temporary Traffic Control requirements shall be met or exceeded as well.
- **NOT TO SCALE—SPACING OF SIGNS, TAPER AND TANGENTS WILL BE SPACED AS PER TABLE HAS SET FORTH AS GOVERNED BY TRAVEL SPEEDS PER CA MUTCD.**
- All traffic devices shall meet or exceed latest CA MUTCD 2014 Edition, Temporary Traffic Control. All signs shall be high intensity night time reflective, 48"x48" roll up signs. All signs shall have a minimum of 2, 18" day time flags attached to sign stands during day time hours and if applicable flashing 12", 12v beacons for night time work.
- Sign stands shall meet latest CA MUTCD 2014 Edition, Temporary Traffic Control, as well as allowing for 18" to 7' height for signs and spring equipped for windy conditions.
- All hours of work shall be dictated by the County specified lane closure charts or as directed by the County Inspector.
- Vehicle path of travel shall never be less than 12' in width. Closures and excavation not to exceed what forces expect to excavate per the daily shift.
- Roadway shall not be opened until safe for public use. All open trenches must be plated or backfilled prior to public usage.
- All areas of excavation must have a valid USA dig tag with corresponding dig ticket number. Proof must be carried with the excavating forces at all times.
- Access to all properties shall be maintained at all times except when work is occurring at the access point. Minimal delays will be allowed to provide access within the work zone area. Driveway access shall be fully restored at the end of each workday.